

Features

The BT027-180 fuse terminal is made of copper with tin plated surface. It is mainly used for connections in electrical circuits. This specification refers to model BT027-180 .

- Material: copper H65, semi-hard
- Thickness: 0.8mm
- Pb- and Halogen-free, RoHS compliant
- Smooth Surface
- Soldering temperature: 260±5°C
- Matte-Tin plated, coating thickness ≥3µm
- Hole flanging height at least 2.2mm; diameter Φ3.2±0.2mm

Dimensions (unit in mm)

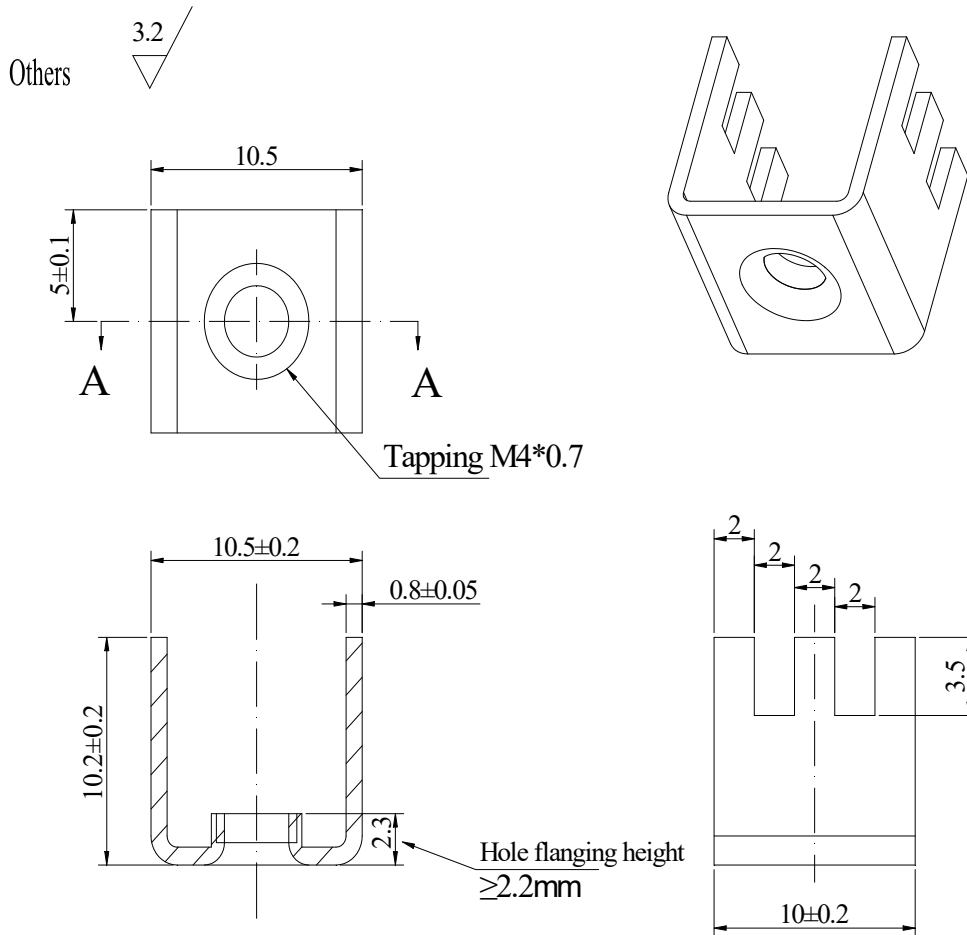

Ordering Information

Series	Part No.	Supplementary Code	Qty
BT027-180			

